

HASSELBOROUGH BAY

B U C K L E S  
B A Y

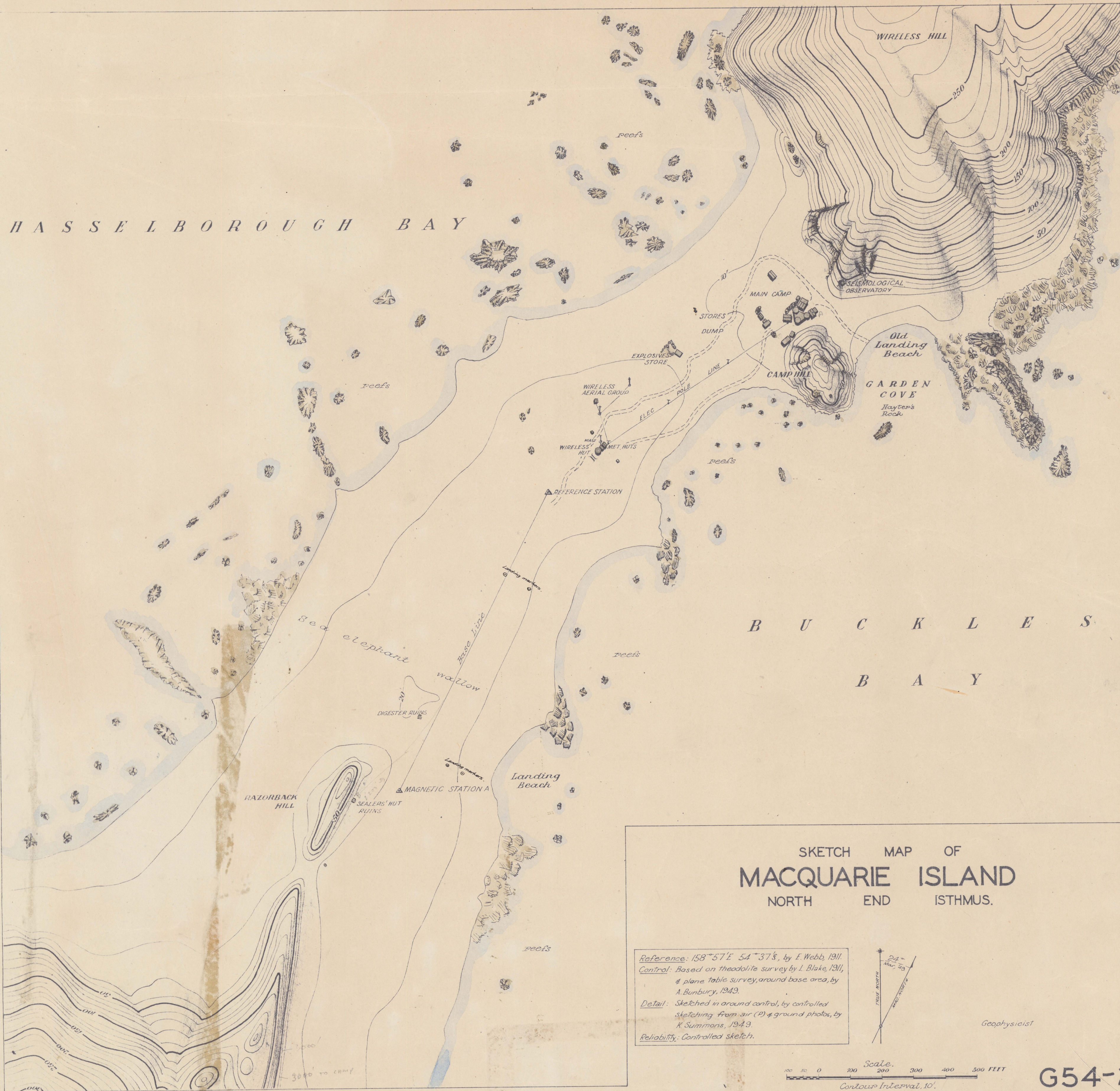

SKETCH MAP OF  
**MACQUARIE ISLAND**  
 NORTH END ISTHMUS.

Reference: 158°57'E 54°37'S, by E. Webb, 1911.  
 Control: Based on theodolite survey by L. Blake, 1911,  
 & plane table survey, around base area, by  
 A. Bunbury, 1949.  
 Detail: Sketched in around control, by controlled  
 sketching from air (P) & ground photos, by  
 K. Simmons, 1949.  
 Reliability: Controlled sketch.

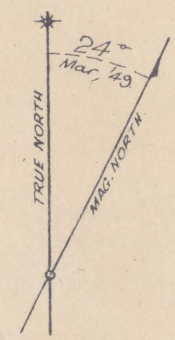

Geophysicist

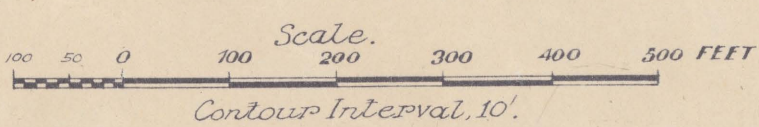

G54-2

Compiled & drawn by Geophysical Section, Bureau of Mineral Resources, Geology and Geophysics, May 1949.

786/1/17

\*7786-2/1